



The **Terminator U** by **HCi**, is a 150 lb ANSI flange union adaptor. These adaptors are available with Grooved or Weld end connections. Rigid adherence to tight quality control standards insure that all flange union adaptors make the grade even in the most demanding services.

The **Terminator U** can be installed effectively in a vertical or horizontal pipeline. Raised-face flange comes standard (3) accessory tapings. It is generally acceptable to thread brass accessories in the steel flange. The accessory ports are welded half couplings. The 1/4", 1/2" and 3/4" porting option can be placed at any (4) clock positions: 12:00, 3:00, 6:00 & 9:00.

Pressure/ Temperature Ratings:

2-1/2"-12": 200 PSI WOG Non - Shock
All Sizes: 225 Deg. F. Maximum

Optional Accessories:

- Drain Valve - Air Vent - PT/Port Accessory/Extension
- Pressure/Temperature Port - Pressure/Temperature Gauges

Dimensional Information & Material Specifications:

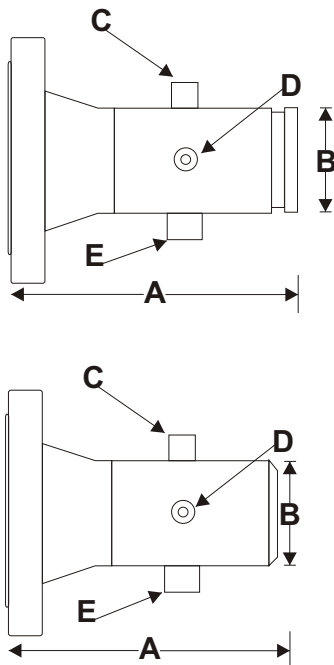

Model #	Size	A	B	C	D	E	
FA250	2-1/2"	6.75	2.47	3/4"	1/4"	1/2"	FNPT TAPS
FA400	4"	7.00	4.03	3/4"	1/4"	1/2"	FNPT TAPS
FG600	6"	7.50	6.07	3/4"	1/4"	1/2"	FNPT TAPS
FA600	6"	7.50	6.07	3/4"	1/4"	1/2"	FNPT TAPS
FG800	8"	8.00	7.98	3/4"	1/4"	1/2"	FNPT TAPS
FA800	8"	8.00	7.98	3/4"	1/4"	1/2"	FNPT TAPS

Flange Body:	Forged Steel ANSI 150 LB Class
Readout Port Body & Cap:	Extruded Brass

Typical Specifications:

Furnish and install where indicated on plans **Terminator U** terminal unit flange union adaptors as provided by **Hydronic Components, Inc.** Flange union shall be rated for 200 PSI WOG service. Flanges shall be forged steel ANSI 150LB class. Raised-face flanges shall come standard with (3) accessory tapings and are available with grooved or weld end connections.

JOB: _____ ENGINEER: _____
REP: _____ CONTRACTOR: _____